

---

**LARIN**®

Owner's Manual

**Model CP-2**  
2 Ton Cable Puller

---

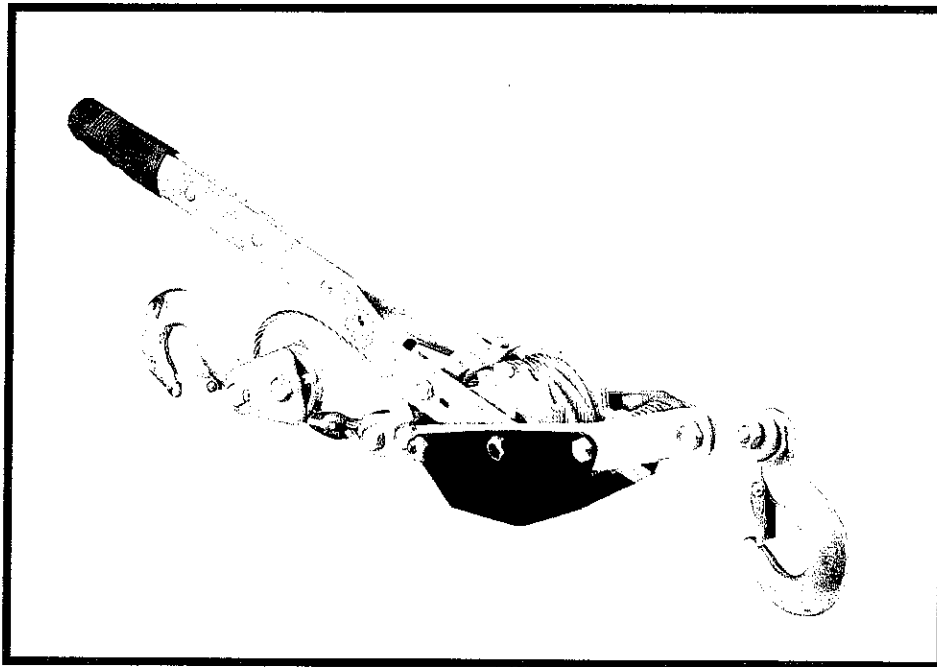

**WARNING**



Read all instructions and safety warnings before using this equipment. Failure to follow the instructions and safety warnings may result in personal injury and/or property damage.

For Customer Service Call Toll Free:  
1-800-87-LARIN (1-800-875-2746)  
Monday – Friday 8:00am to 4:30pm PST

**IMPORTANT:** Please keep your receipt in a safe, easy to find location, as you will need it for any warranty/repair issues that may arise.

## TABLE OF CONTENTS

Important Warning Information .....	1
Parts List/Parts Diagram .....	2-3
Operating Instructions.....	3-4
Maintenance/Inspection .....	4
Additional Safety Instructions .....	4
Warranty/Replacement Parts .....	5

## IMPORTANT WARNING INFORMATION

### Owner/Operator Responsibility

The owner and/or operator shall study and understand the product instructions and warnings before operating the product and retain them for future reference. If the operation is not fluent in English, the product and safety instructions shall be read to and discussed with the operator in the operator's native language by the purchaser/owner or his designee, making sure that the operator comprehends their contents.



## WARNINGS



1. Read, study, understand and follow all instructions and warnings before using this product.
2. Do NOT exceed the rated capacity.
3. ALWAYS keep tension on the cable while operating.
4. Do NOT subject the cable puller to sudden shock loads.
5. Avoid abrupt handle movement when releasing the load. Apply pressure with an even, steady force.
6. Do NOT use handle extension device or "cheater" pipe to lengthen the handle. This will damage the cable puller and the load.
7. Do NOT allow anyone around or under the tensioned load.
8. Do NOT operate the product if it has a frayed, kinked, twisted or damaged cable.
9. Do NOT wrap the cable around the load or around any other object.
10. Do NOT hook back onto the cable puller.
11. Do NOT pull the cable over or around a corner.
12. Do NOT use the cable puller as a hoist. It is not designed as a lifting device.
13. Do NOT use the cable puller as a towing device.
14. ONLY use hand power to operate the product.
15. ALWAYS make sure that there is a positive engagement of the puller hook to the load.
16. ALWAYS make sure that the hooks are secured to load before tensioning.
17. Do NOT operate the cable puller with less than 3 wraps of cable on the drum.
18. NO alterations shall be made to this product.

## PARTS LIST

Please make sure that no parts are missing before operating.

Ref No	Qty	Description	Ref No	Qty	Description
1	1	Cable Assembly	20	1	Drive Pawl
2	3	Bolt M8x70	21	1	Casing Pipe M
3	3	Casing Pipe L	22	1	Nut M6
4	1	Double Ratchet Wheel	23	1	Elastic Ring $\varnothing$ 6
5	3	Elastic Ring $\varnothing$ 8	24	1	Bolt M6x60
6	3	Nut M8	25	1	Handle Case
7	1	Bolt M8x25	26	1	Drive Spring
8	1	Elastic Ring $\varnothing$ 8	27	1	Pulley
9	1	Nut M8	28	1	Hanger Sheet
10	2	Hook Assembly	29	2	Casing Pipe S
11	1	Hanger	30	2	Bolt M8x25
12	1	Hanger Joint	31	2	Elastic Ring $\varnothing$ 8
13	1	Hanger Pin	32	2	Nut M8
14	1	Ringent Ring $\varnothing$ 6	33	1	Guide Clip
15	2	Frame	34	1	Bolt M6x14
16	1	Bottom Frame	35	1	Nut M6
17	1	Stop Pawl	36	1	Pin
18	1	Stop Spring	37	1	Ringent Ring $\varnothing$ 6
19	1	Handle Assembly	38	1	Switch

## PARTS DIAGRAM

Illustration A

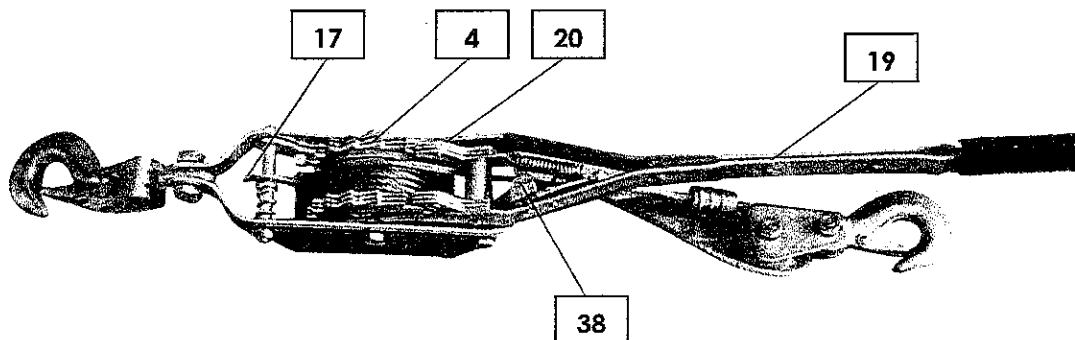

## PARTS DIAGRAM

Illustration B

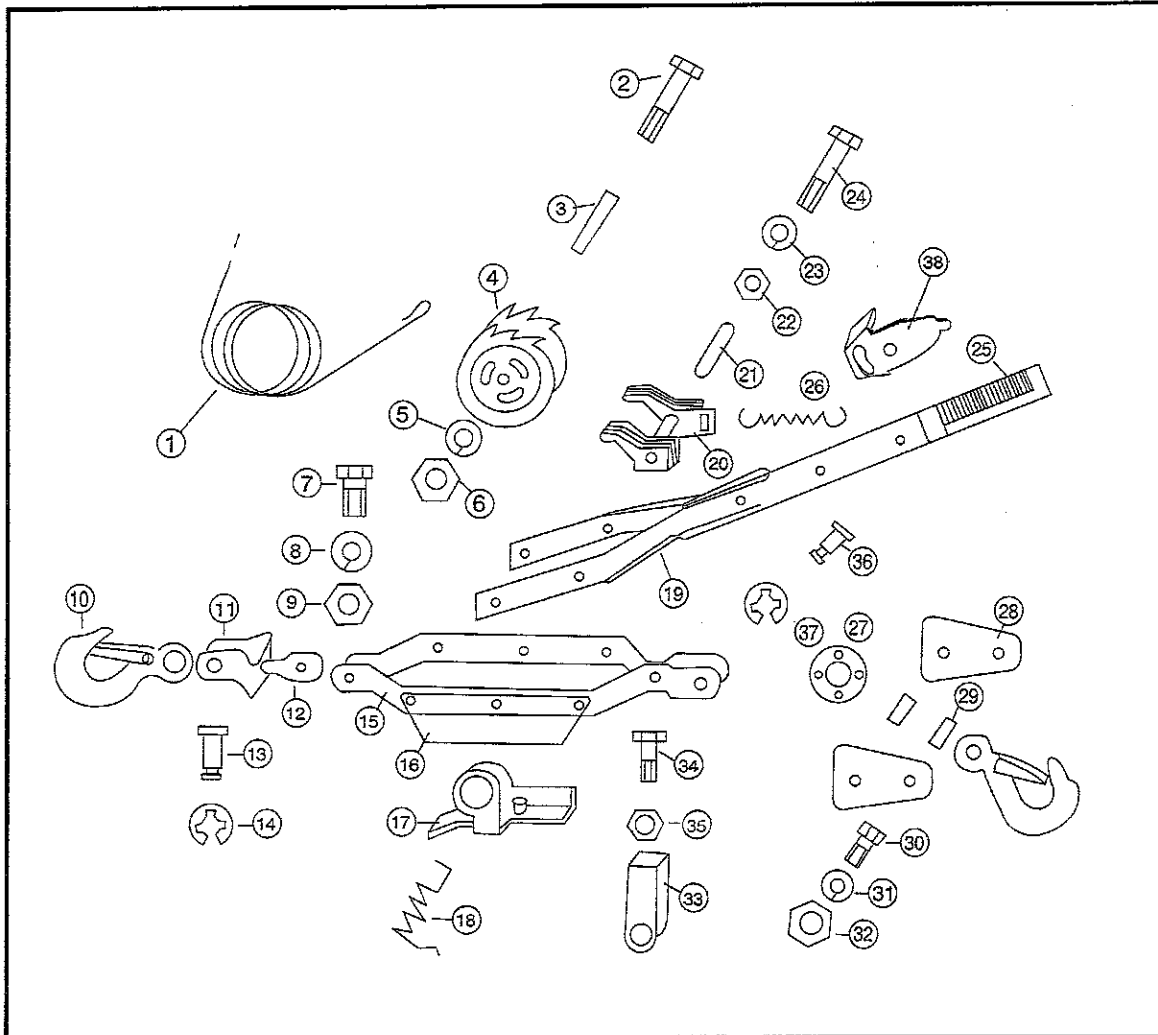

## OPERATING INSTRUCTIONS



### WARNING!

Never attempt to disengage Stop Pawl while under tension from load.

1. Attach fixed hook (10) to a stationary object.
2. Hold cable puller in an upright position. Move switch (38) to up position. Press stop pawl lever (17) upward to release tension on ratchet wheel (4). Pull cable out to desired length.
3. Attach cable hook (39) to the object to be moved.
4. Press switch (38) down.

5. Pull the object by firmly gripping the handle (19) and moving it back and forth with an even, steady force. This will allow the cable to be reeled in, moving the object.
6. After moving object to desired location, move switch (38) to up position. Next move handle (19) all the way toward fixed hook (10) until it engages the stop pawl (17). Push handle (19) down, and then raise it up. This releases tension one notch at a time. Repeat this motion until there is enough slack to unhook the cable puller from the object.

## **MAINTENANCE**

1. Visual inspection MUST be made prior to each use of the cable puller. Check for bent, worn, kinked, frayed or damaged parts. Any cable puller that appears to be damaged in any way should not be used until a manufacturer or supplier's authorized repair center makes necessary repairs.
2. Inspect cable puller immediately if it has been subjected to abnormal load or shock. It is recommended that a manufacturer or supplier's authorized repair center make this inspection.
3. Keep cable puller free from dirt, grease or other debris.
4. Any cable puller that appears to be damaged in any way or operates abnormally shall be removed from service immediately.
5. BECAUSE OF THE POTENTIAL HAZARDS ASSOCIATED WITH THE MISUSE OF EQUIPMENT OF THIS TYPE, NO MODIFICATIONS SHALL BE MADE TO PRODUCT.

## **ADDITIONAL SAFETY INSTRUCTIONS**

- Understand the application, limitations and potential hazards associated with the cable puller.
- Keep work area clean and clutter-free.
- Do Not wear loose or ill fitting clothing. Remove ties, watches, rings and other loose jewelry. Contain or tie back long hair.
- Keep children and non-essential persons away from the operating area. Be aware of the location of other persons assisting you.
- Do NOT operate the puller if you are tired or under the influence of alcohol, drugs or intoxicating medications.
- Store equipment when not in use. Keep in dry location and out of reach of children.
- Use appropriate safety equipment for the job such as eye/ear protection.

## **WARRANTY INFORMATION**

### **ONE YEAR LIMITED WARRANTY**

**Must provide copy of receipt for Warranty – Keep receipt in safe location.**

Larin Corporation warrants this product for a period of one year from date of purchase against manufacturer or material defects as long as you own this product. This warranty does not cover damage caused by accident, misuse, or tampering/altering of the product and a charge will be made for such repairs.

This warranty gives you specific legal rights, which vary, from state to state.

This warranty excludes all consequential damages. Some states do not allow the exclusion of consequential damages, so the foregoing exclusions may not apply to you. For warranty service, please return the product prepaid to Larin Corporation, 2029 Business Parkway, Ontario, California 91761. Be certain to include your name and address, phone number, proof of purchase date and description of the problem and the repaired or replaced product will be sent to you freight collect.

#### **IMPORTANT**

No liability is accepted for incorrect use of product.

#### **RETURN POLICY**

**DO NOT** return unit to store where purchased if upon receipt and inspection you discover missing or defective parts. Please call toll free (800) 875-2746, Monday – Friday 8:00am to 4:30pm PST. We will send you the parts free of charge with proof of purchase. In case the unit needs to be returned, it should be packed in the original box. The serial number on the unit and box should match.

#### **LARIN CORPORTION**

2029 Business Parkway, Ontario, CA 91761 USA

**Phone:** 909-923-1399 **Fax:** 909-923-0969 **Toll Free:** 800-87LARIN (875-2746) **E-Mail:** [Sales@larincorp.com](mailto:Sales@larincorp.com)

**Hours of operation:** Monday through Friday, 8:00am to 4:30pm PST