

INSTALLATION INSTRUCTIONS

VEHICLE	HITCH NO.
FORD EXPLORER SPORT TRAC	75112
	33020
	87008

EQUIPMENT REQUIRED:

WIRING ACCESS LOCATION: SUV1, SUV2

DRILL BITS:

HITCH REQUIRES 5/8" PIN AND CLIP IF STABILIZING PIN (7651) IS NOT INSTALLED.

WRENCHES: (TIGHTEN ALL FASTENERS WITH TORQUE WRENCH) 13/16, 7/8, 15/16

DO NOT EXCEED LOWER OF
TOWING VEHICLE MFR'S RATINGS OR

HITCH TYPE ▼	MAX GROSS TRLR WT(LB)	MAX TONGUE WT(LB)
WEIGHT DISTRIBUTING	6000	600
WEIGHT CARRYING BALL MOUNT	5000	500

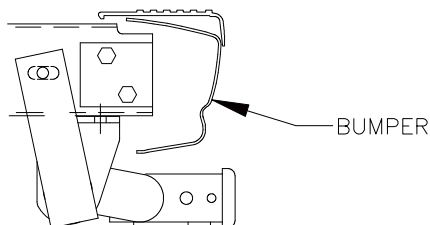

BUMPER

HITCH SHOWN IN PROPER POSITION

9/16-12 X 2-1/2 GR5
BLOCK 1/4 X 1-1/2 X 2
(1097-006)
BLOCK 3/8 X 1-1/2 X 2
(4390)

LOCK WASHER
NUT

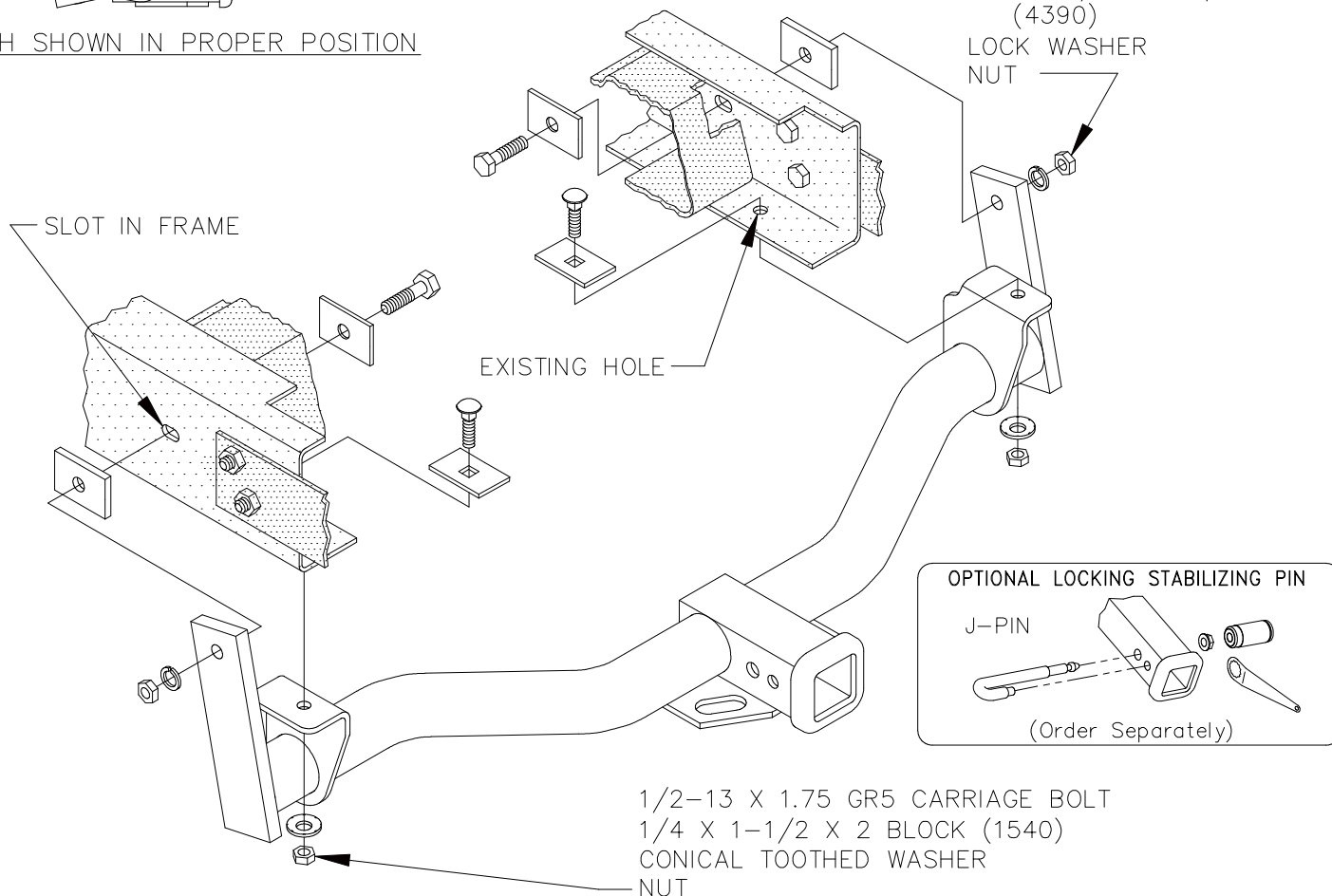

OPTIONAL LOCKING STABILIZING PIN

J-PIN

(Order Separately)

1/2-13 X 1.75 GR5 CARRIAGE BOLT
1/4 X 1-1/2 X 2 BLOCK (1540)
CONICAL TOOTHED WASHER
NUT

1. RAISE RECEIVER INTO POSITION AND ATTACH WITH FASTENERS AS SHOWN ABOVE.

TIGHTEN ALL 1/2" GR5 FASTENERS TO 75 LB.-FT.
TIGHTEN ALL 9/16" GR5 FASTENERS TO 110 LB.-FT.

THIS PRODUCT COMPLIES WITH SAFETY SPECIFICATIONS AND REQUIREMENTS FOR CONNECTING DEVICES AND TOWING SYSTEMS OF THE STATE OF NEW YORK AND V.E.S.C. REGULATION V-5.

APPROX WEIGHT (LB.)	FASTENER KIT
34	F75112

NOTE: Check hitch frequently, making sure all fasteners and ball are properly tightened. If hitch is removed, plug all holes in trunk pan or other body panels to prevent entry of water and exhaust fumes. A hitch or ball which has been damaged should be removed and replaced. Observe safety precautions when working beneath a vehicle and wear eye protection. Follow car maker's specs for maximum trailer weight and tongue weight. Do not cut access or attachment holes with a torch.

TOWING PRODUCTS
Plymouth, Michigan