

EFP - GEN Y - Murda Out 3011230

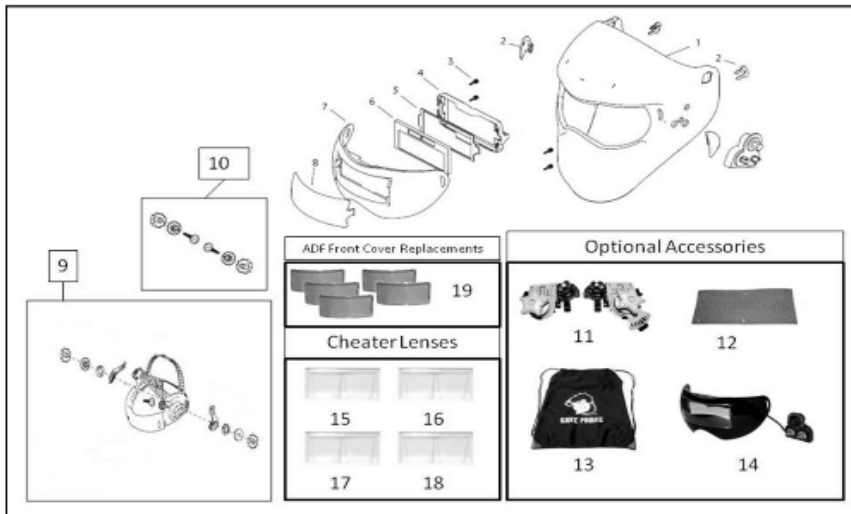

Figure #	Part Number	Description	No. Req'd
1	N/A	Hood	1
2	3010219	Lens Key and Anchor, Left and Right	1
3	3010110	ADF Screw	1
4	3010103	ADF Back Cover	1
5	3010127	BACK COVER 5PK GEN Y	1
6	3010936	ADF LENS FOR S	1
7	3010080	ADF HOLDER/PASSIVE LENS	1
8	3010097	SP EFP ADF FRNT CVR REPL 1 PK	1
9	3011544	HALO	1
10	3011551	Halo KNOB SET	1
11	3011483	Hard Hat Adapter (Optional accessory, not originally included with product)	1
12	3010196	Replacement Halo Foam	1
13	3010226	Replacement Protective Bag (Optional accessory, not originally included with product)	1
14	3010929	EFP-Complete ADF Assembly - Gen Y	1
15	3010240	Cheater Lens - Mag 1.0 (Optional accessory, not originally included with product)	1
16	3010257	1.5 CHEATER LENS (Optional accessory, not originally included with product)	1
17	3010264	2.0 CHEATER LENS (Optional accessory, not originally included with product)	1
18	3010271	2.5 CHEATER LENS (Optional accessory, not originally included with product)	1
19	3010691	SP EFP ADP FRT COVER REPL 5PK (Optional accessory, not originally included with product)	1

Notes From the date of the end user purchase, Save Phace will warranty or repair (At its option) it's products for one (1) year against defects in parts and workmanship. Any product of Save Phace that contains an ADF (Auto Darkening Filter) will carry a 24 month warranty on the ADF only and the remaining portion of the helmet will have a 12 month warranty protection against manufacturer defect. In the parts breakdown there are items that are listed as optional. These are additional accessories to the particular item that are not originally included with that item. These are considered a service part and carry a 90 day warranty from the date of the end user purchase. All other service parts carry a 90 day warranty as well if purchased individually with the exception of the ADF. The ADF will still carry a 24 month from the date of end user purchase warranty. To obtain warranty considerations please contact 1-888-332-6419, 1-888-332-6419 FREE or e-mail SavePhaceSupport@SFACompanies.com to obtain either an RMA or Service Part. Items should not be sent directly back without prior approval from manufacturer and an RMA issued from the manufacturer. In order to warranty a complete item an RMA must be made from the manufacturer, Not Matco, and provided to the distributor with instructions on how to proceed. A copy of the proof of purchase is required for all warranty considerations. For questions regarding warranty or warranty procedures please contact 1-888-332-6419, 1-888-332-6419 FREE.

<b>Series</b>	<b>Gen Y</b>	<b>Switching Time at 23°C</b>	0.3ms
<b>Filter Dimension</b>	4.25" x 2"	<b>Sensitivity &amp; Delay Time Control</b>	YES
<b>View Size</b>	3.74" x 1.38"	<b>Time From Dark to Light</b>	0.1-0.9s adjustable
<b>Warranty</b>	24 months	<b>Grinding Function</b>	YES
<b>Classification</b>	1/1/1/2	<b>Grinding Warning Flash</b>	NO
<b>Sensors</b>	2	<b>Low Battery Warning Indicator</b>	NO
<b>Light State</b>	4	<b>Operation Temperature</b>	-10°C- 65°C (14°F-149°F)
<b>Dark State</b>	Variable shade 9-13	<b>Power Supply</b>	Solar Cell & Replaceable Battery
<b>Power Control</b>	Fully automatic	<b>Lowest Current Amp</b>	5A
<b>Shade Control</b>	YES, EXTERNAL	<b>Interchangeable Lenses</b>	NO
		<b>Cheater Lens Compatible</b>	YES