

Important Safety Information

Read and understand all safety precautions and instructions before use.

- The Handy Grubber is designed for outdoor use.
- Check the Handy Grubber before each and every use for signs of wear. Do Not use if damaged or if not working properly
- The Handy Grubber is designed to remove brush up to 4" diameter
- The Handy Grubber is not to be used on people or pets.



Instructions

1. To open the jaws on the Handy Grubber pull back on the lever inside the "D" grip handle.
2. Place one grip pad of the Handy Grubber on each side of trunk of brush near the base/ground with **spring on the Handy Grubber placed towards the ground** as shown in figure 1.
3. Release the lever inside the "D" grip handle and pull to extract the plant including the roots.
4. To remove the Handy Grubber from the trunk of brush pull back on the lever inside the "D" grip handle.

***Take caution of all pinch points on the Handy Grubber.**

***Take caution of Grip Pads when opening & closing the jaws of the Handy Grubber. Keep fingers and hands free and clear.**

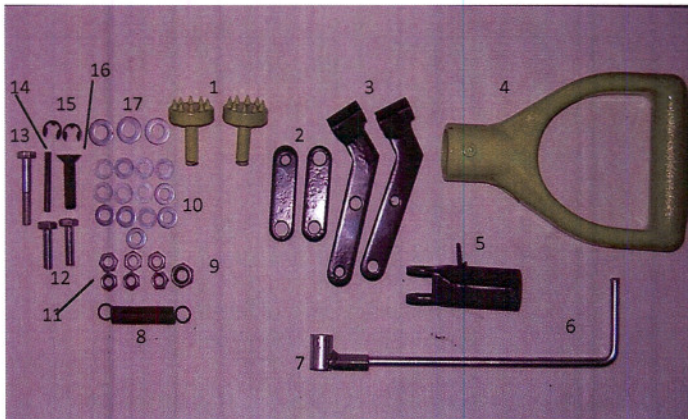

Ref. #	Qty	Part #	Description
1	2	BG02-24	Grip Pad
2	2	BG02-08	Clevis Arm
3	2	BG02-05	Main Arm
4	1	BG13-01	D-Grip Handle
5	1	BG13-02	Handle Shaft
6	1	BG13-03	Lever
7	1	BG13-08	Lever Connector
8	1	BG02-07	Spring
9	1	BG02-25	Lock Nut M10
10	13	BG02-22	Washer Ø8
11	6	BG02-18	Nut M8
12	2	BG13-04	Hex Bolt M8x35
13	1	BG02-14	Hex Bolt M8x50
14	1	BG13-05	Roll Pin
15	2	BG-13-06	E-Clip Ø8
16	1	BG02-16	Bolt M10x40
17	3	BG13-07	Washer Ø10



WARNING

BAC Industries, Inc. and Brush Grubber will not be held liable for any damages, losses, or injury, due to misapplication or misuse of this product or for any other reason. Always wear approved safety glasses, protective clothing, and proper hand and foot protection at all times. Keep all people and pets or animals clear from brush removal work area.

Brushgrubber.com
PO Box 155
Miltona, MN 56354

PH: 218-943-6290

www.brushgrubber.com

Email: info@brushgrubber.com

See other unique items at BrushGrubber.com