

### Operational and Safety Instructions

FAILURE TO UNDERSTAND AND FOLLOW ALL SAFETY RULES AND OPERATIONAL INSTRUCTIONS COULD RESULT IN SERIOUS INJURY OR DEATH.



#### METAL CONDUCTS ELECTRICITY:

Do not use this equipment where contact may be made with power lines or other live electrical circuits.

#### OPERATIONAL INSTRUCTIONS

##### STEP 1: EXTENDING THE LADDER

1. Release the securing strap.
2. Extend ladder with latches facing user.
3. The ladder extends and locks in 1 ft (30 cm) increments.
4. Place ladder on firm and level surface.
5. Place your foot on the bottom rung to hold ladder in place.
6. With both hands, pull up on the couplings of the 3rd rung from the bottom.
7. Make sure that each rung is pulled up to its full extension and locks before attempting to extend the next rung.
8. Extend desired number of rungs to achieve required height
9. When the ladder is fully extended, do not stand or step on last top three rung of the ladder.

**TIP:** To extend the ladder to its fullest height, pull-up on the top rung first, raising the rung to its full extension, making sure it locks in place. Then continue with each remaining rung. Again making sure that each rung locks in place before extending the next rung.

##### STEP 2: CLOSING THE LADDER

**GREAT CARE SHOULD BE USED WHEN CLOSING LADDER.** Do not place any part of your body including hands, fingers or thumbs on, or between rungs or couplings above the dosing rung.

1. The ladder closes and locks in 1 ft (30 cm) increments.
2. Grasp the ladder by the couplings below the rung that you are activating the latches.
3. Place thumbs on latches that you wish to disengage.
4. Place the rest of your hand below the coupling.
5. Simultaneously, push latches inward (towards each other) until the above rung is lowered.
6. Repeat this operation with each rung.

##### STEP 3: CARRYING THE LADDER

Replace the "securing strap", Grab the ladder by the grip handle located underneath the 2nd rung, Do not lift the ladder by the rungs. It may open and cause injury to the user and damage the ladder as well.

#### COMPONENTS OF A TELESCOPIC LADDER



- RUNG
- STILE
- PLASTIC COUPLING
- LATCHES
- GRIP HANDLE
- SECURING STRAP
- RUBBER FOOT

#### SAFETY INSTRUCTIONS

- Read all safety instructions before using the ladder.
- When extending the ladder, make sure that the ladder is securely standing on level, solid, slip free surface.
- Improper hand or finger position may cause injury.
- Lean ladder only with the top end of rungs against a firm structure, never against the stiles. Doing this may cause stile damage and void the warranty.
- Do not attempt to extend the ladder while climbing or standing on the ladder.
- For your security group unused section at top for safe climbing.
- If ladder becomes damaged, it may malfunction and should not be used.
- Do not carry or use the ladder near electrical lines or equipments. The ladder does conduct electricity.
- Store ladder in a dry place to avoid moisture.
- Do not use as a sawhorse.
- Ladder is not designed for use in water or in the rain.
- If ladder becomes wet, wipe immediately with a clean dry towel.
- **Attention:** Winter condition may affect the retracting mechanisms.

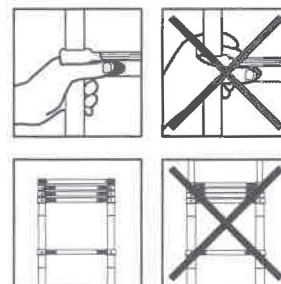

**IMPROPER  
HAND OR FINGER  
POSITION MAY  
CAUSE INJURY.**

**FOR YOUR  
SECURITY GROUP  
UNUSED SECTION  
AT TOP FOR SAFE  
CLIMBING.**

All photos and drawings in this booklet are for reference purposes only. Refer to applicable codes and regulations for the proper use of this equipment.

### Maintenance Tips

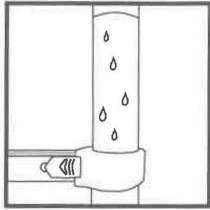

#### WET LADDER

If the ladder is wet or if there is water on the ladder, open the ladder to the maximum and, with a dry cloth, absorb the water. It is recommended to let the ladder dry fully opened, on one side and then on the other, with the ladder leaning against a wall.

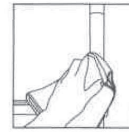

DRY



LET DRY

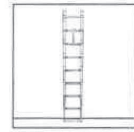

TURN

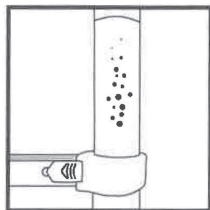

#### OXIDIZED LADDER

If the ladder is oxidized (due to previous poor drying), there will be white residue on the stiles. First, remove the spots with a dry cloth. Then, to ensure the ladder deploys and retracts correctly, use a silicone based lubricant once the ladder is fully opened and dry it correctly. Wait a few minutes and close the ladder. Never use a cleaner such as WD-40 - it will dry the internal mechanism of your ladder.

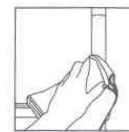

CLEAN

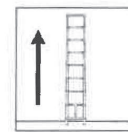

EXTEND



LUBRICATE



WD-40

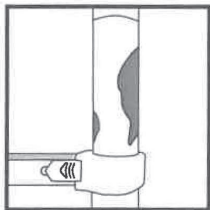

#### PAINT OR OTHER SUBSTANCES STICKING TO STILES

If paint residues were left on the ladder, they must be removed using a slightly abrasive sponge. Do not use steel wool since it might damage the opening/closing mechanism. After all residues have been removed from the stiles, apply a lubricant as indicated in above section "Oxidized ladder"

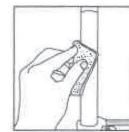

CLEAN



LUBRICATE

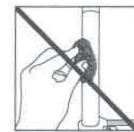

STEEL WOOL

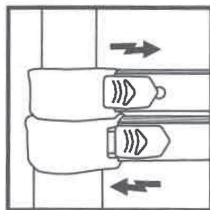

#### HARD TO PUSH LATCHES

If the latches are hard to push, use a compressor or a compressed air duster to properly clean the latches. Then, lubricate the latches (with a silicone based lubricant) with a forward/backward movement. Dry lubricant with a dry cloth.

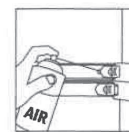

CLEAN

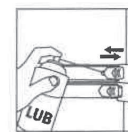

LUBRICATE

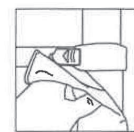

DRY

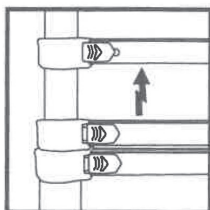

#### DIFFICULTY IN OPENING OR CLOSING THE LADDER

If it becomes hard to open or close the ladder. Fully extend the ladder, clean it, and lubricate the stiles with a silicone based lubricant. If the rungs are jammed, use lubricant on every rung and close the ladder for 15 to 20 minutes to let the lubricant penetrate the ladder. Then, open and close the ladder to ensure the lubricant reaches every area of the ladder. Before storing the ladder, apply lubricant to the stiles.

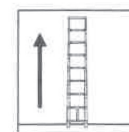

EXTEND

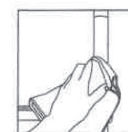

CLEAN



LUBRICATE

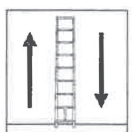

OPEN & CLOSE

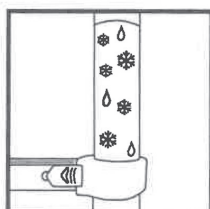

#### WINTER CONDITIONS

If the opening/closing of the ladder are affected by winter conditions, open the ladder in a dry area until the stiles reach room temperature i.e. 18 to 21°C. Ensure there is no humidity left on the stiles and couplings. (if there is humidity or oxidation, please refer to section "Wet ladder" or "Oxidized ladder"). Finally, with the ladder opened, lubricate all the stiles.

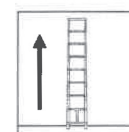

EXTEND

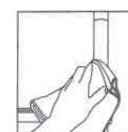

DRY



LUBRICATE