

RAIDER®

DELUXE MINI DOLLY SET

PN: SM-12165

ASSEMBLY INSTRUCTIONS

• You will need a 14MM wrench to properly assemble and snug down the nut hardware



STEP ONE

Remove all pieces of the kits from the box and review the inventory (shown to the left)

STEP TWO

Secure casters (image notation #3) to the ski mini dollies (image notation #1 and #2). Tighten the M10 flange nuts firmly. (Image notation #4)

STEP THREE

Upon securing all of the wheel casters to each of the dolly platforms - be sure to go over each nut again to ensure it is firmly tightened to avoid any loosening / caster failure

- 1 Small square mini dolly (Smaller black plate)
- 2 Track dollies (Larger black plates with grooves)
- 12 Wheel casters
- 12 M10 Flange nuts

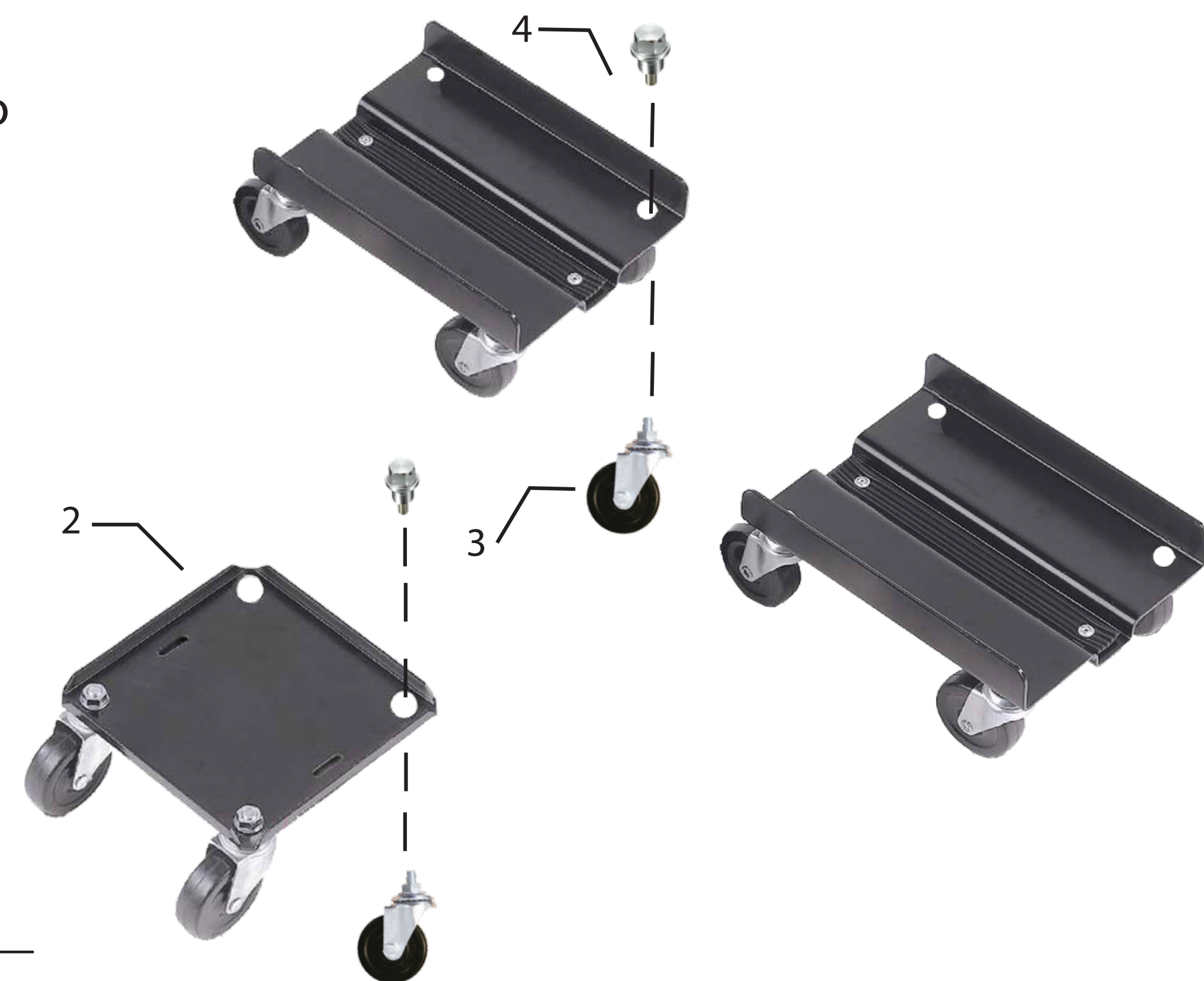

PRODUCT WARRANTY

Please visit www.raiderpowersports.com for product warranty and terms and conditions of sale applicable to this product. You are also welcome to call RAIDER® customer service at 888-965-3700, or email info@4bcs.com - and we will forward a copy to you.