

Assembly and Instructions

Notes:

1. Choose an appropriate location for your fountain.
2. While fountain is designed to operate as splash free as possible, some water splashing out of the fountain is inevitable. Place your fountain in a location where any splashing will not cause damage.
3. The National Electric Code requires that a ground fault circuit interrupter (GFCI) be used in the branch circuit supplying fountain pump and other pond equipment. See your electrical supplies dealer for this device.
4. Keep your fountain full of water and clean of debris and dirt to ensure proper functioning of the pump.
5. If necessary, clean your fountain with a soft cloth and change the water frequently. Due to water evaporation, you may see a buildup of white residue on the fountain surface from mineral content in the water supply. To prevent such buildup, regularly clean your fountain with soap and water, do not use any abrasive, which may damage the applied finish.
6. See the pump instructions for pump safety, maintenance, and warranty information.
7. To reduce the risk of electric shock, use only on portable self-contained fountains no larger than 5 feet in any dimension.

Installation & Assembly

1. Place the water feature on a level surface, away from areas where it is likely to get clogged with leaves and make sure that the cable will reach the socket.
2. Connect the pump to the flexible hose, then close the cover, see step (1), (2).
3. Insert the finger light into the relevant clip and connect the light cable to transformer, make sure it is fasten before power on.
4. Fill the reservoir with water and make sure the water can submerge the pump fully to prevent pump damage.
5. Plug in and switch on. The water will start to flow soon.
6. Adjust the pump flow rate to achieve the desired effect and to minimize any splashing. Splashing can occur if the flow rate is too high or the reservoir is too full. The flow rate can be increased or decreased by moving the flow rate control slider on the pump body. Moving the switch towards '+' will increase the flow rate and moving it towards '-' will decrease it.

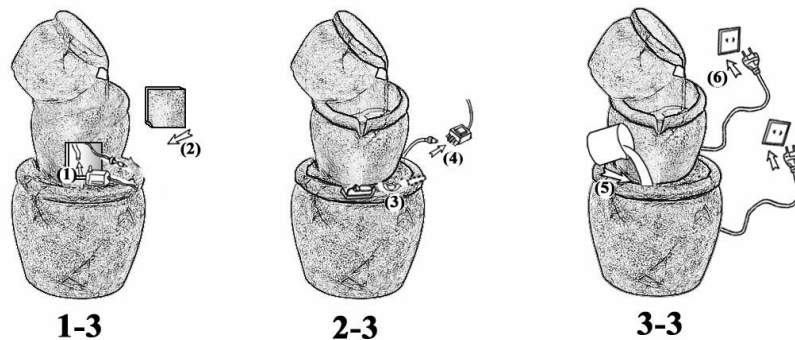

Troubleshooting

1. If pump does not run, check the circuit breaker, try another outlet.
2. Check the water level in the fountain. Running the pump without sufficient water can damage the pump.
3. Check the setting of the flow control on the pump.
4. Check the pump discharge and intake for dirt and debris.

5. Check the fountain feature tubing for kinks and obstructions.
6. Is the pump “air locked”? Plug and unplug the pump several times to clear.
7. Caution: Excessive weight or pressure on any of the fountain sections may cause it to fall. Keep pets, children, or anyone from sitting, leaning, or climbing on any of the fountain components.