

# Assembly Instruction

Y97016

**\*\* WARNING \*\***

**Read these instructions carefully and keep the fountain power off until the following assembly process is strictly completed.**

## Notes:

- Choose an appropriate location for the fountain.
- Excessive weight or pressure on any of the fountain sections may cause it to fall. Keep pets, children, or anyone from sitting, leaning, or climbing on any of the fountain components.
- While fountain is designed to operate as splash free as possible, some water splashing out of the fountain is inevitable. Place the fountain in a location where any splashing will not cause damage.
- The National Electric Code requires that a ground fault circuit interrupter (GFCI) be used in the branch circuit supplying fountain pump and other pond equipment. Seek your electrical supplies dealer for this device.
- Always keep the fountain working with sufficient water and clean of debris and dirt to ensure proper functioning of the pump.
- If necessary, clean the fountain with a soft cloth and change the water frequently. Due to water evaporation, you may see a buildup of white residue on the fountain surface from mineral content in the water supply. To prevent such buildup, regularly clean the fountain with soap and water, do not use any abrasive, which may damage the applied finish.
- See the pump instructions for pump safety, maintenance, and warranty information.
- Keep this manual for future reference.

## Installation & Assembly

- Place the fountain on a level surface, away from areas where it is likely to get clogged with leaves and make sure that the cable will reach the socket.
- Follow steps to assemble as illustrated below.

Figure'1-5'

Step (1) Connect the big plate and pedestal tightly as arrowheads indicates.

Figure'2-5'

Step (2) Get the wire of pump through plastic pipe of big plate centre. Make sure the wire is put into the pedestal's cavity.

Step (3) Connect the pillar and big plate tightly as arrowheads indicate.

Figure'3-5'

Step (4) Connect medium plate and pillar tightly as arrowheads indicate.

Figure'4-5'

Step (5) Put plastic hose into the plastic pipe of medium plate centre then connect top part and medium plate tightly as arrowheads indicate.

Figure'5-5'

Step (6) Connect plastic hose to pump outlet.

Step (7) Please close the small door to the pillar of big plate centre.

Step (8) and (9) Fill the big plate with enough clean water to assure the pump to work properly. Plug the pump, water will start to flow in minutes.

- Adjust the pump flow rate to achieve the desired effect and to minimize any splashing. Splashing can occur if the flow rate is too high or the reservoir is too full. The flow rate can be increased or decreased by moving the flow rate control slider on the pump body. Moving the switch towards '+/ Max.' will increase the flow rate and moving it towards '-/Min' will decrease it.  
On some type of pumps, flow regulator may be turned clockwise or counterclockwise to adjust.

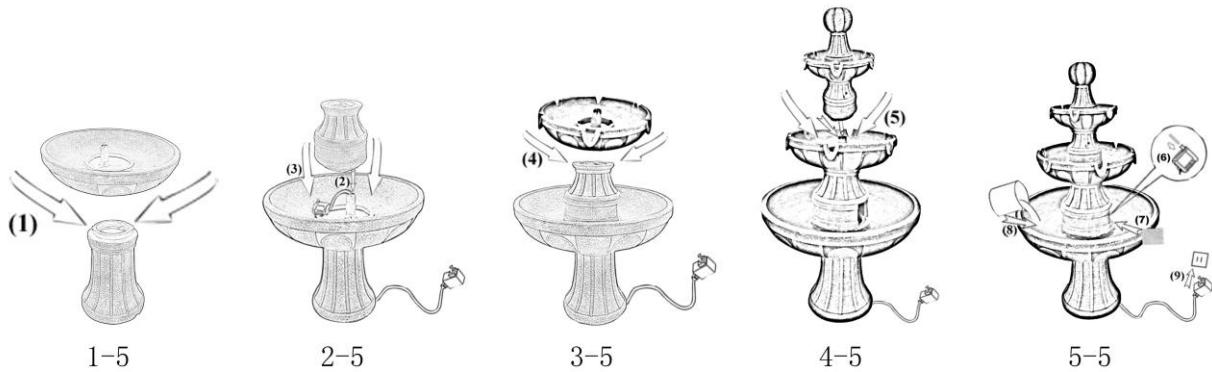

## Troubleshooting

- - TURN OFF THE POWER BEFORE YOU CHECK FOLLOWING - -

If pump does not run, --

- (1) Check the circuit breaker, try another outlet.
- (2) Check the water level in the fountain. Running the pump without sufficient water can damage the pump.
- (3) Check the setting of the flow control on the pump and adjust the flow.
- (4) Check the pump discharge and intake for dirt and debris.
- (5) Check the fountain feature tubing for kinks and obstructions.
- (6) The pump might be "air locked". Plug and unplug the pump several times to release the air inside the pump.
- (7) Check and reconnect all the cords and try again.

IF YOU HAVE QUESTIONS OR CONCERNS

PLEASE CALL BOND TOLL FREE #

1-866-771-BOND (2663) OR TO BETTER

EXPEDITE YOUR REQUEST FEEL FREE TO EMAIL US

[customerservice@bondmfg.com](mailto:customerservice@bondmfg.com)

OR LOG IN TO OUR WEBSITE UNDER CUSTOMER SERVICE SUPPORT

[www.bondmfg.com](http://www.bondmfg.com)