

# INSTALLATION INSTRUCTIONS

EQUIPMENT REQUIRED:

WIRING ACCESS LOCATION: SUV1, SUV2

DRILL BITS:

HITCH REQUIRES 1/2" PIN AND CLIP

WRENCHES: (TIGHTEN ALL FASTENERS WITH TORQUE WRENCH) 18mm, 19mm

VEHICLE

HITCH NO.

CHRYSLER TOWN & COUNTRY

24702

DODGE CARAVAN

77012

PLYMOUTH VOYAGER

(FITS ALL MODELS 2WD, 4WD,  
SHORT, & LONG WHEEL BASE)

2000 LB MAX GROSS TRAILER WT  
200 LB MAX TONGUE WEIGHT  
DO NOT EXCEED TOWING VEHICLE RATINGS

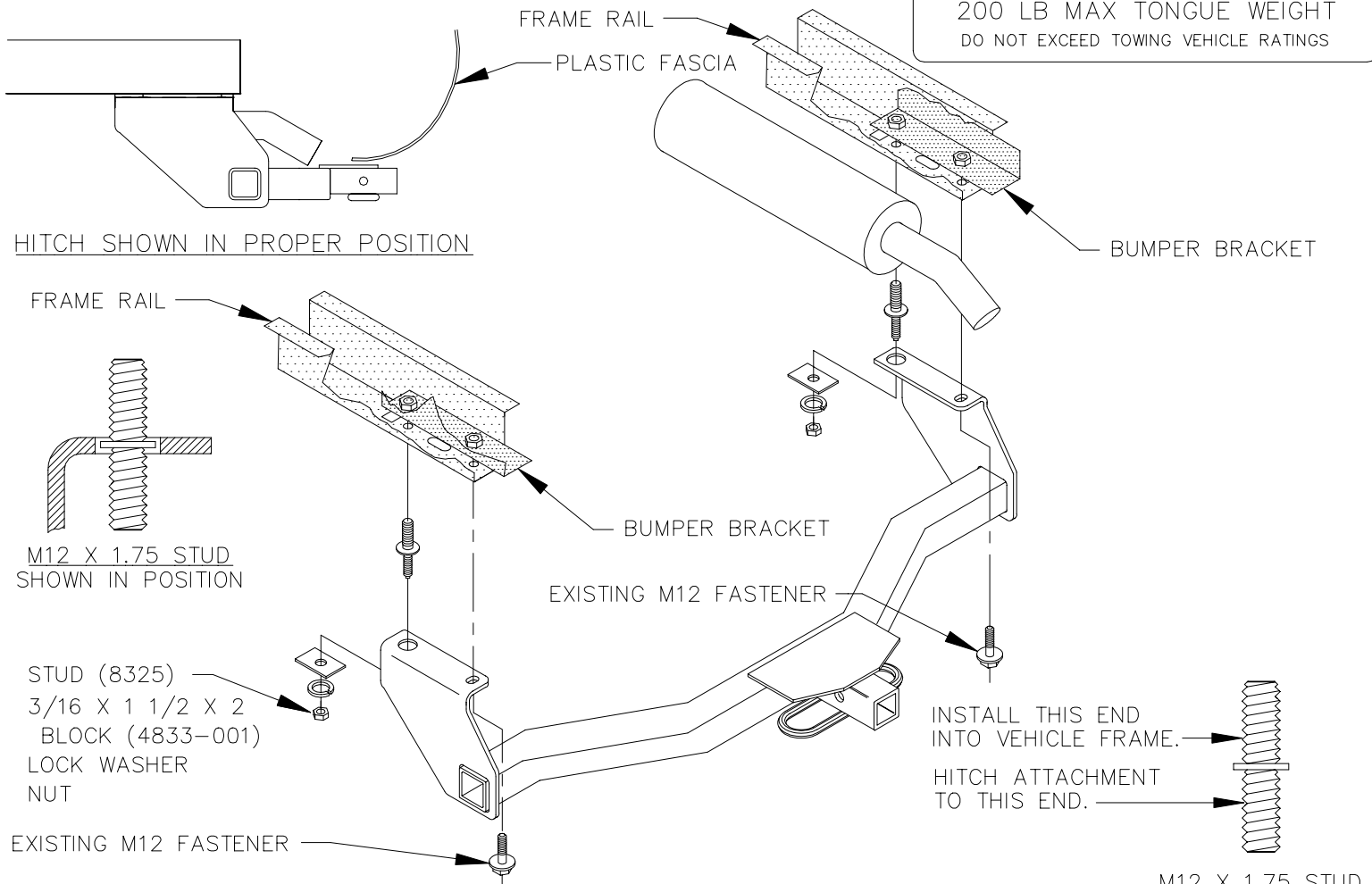

1. REMOVE ONLY THE FORWARD BUMPER BOLTS - BOTH SIDES.
2. INSTALL THE M12 X 1.75 STUD INTO POSITION, UNTIL SEATED TO FRAME, WHERE BUMPER BOLT WAS REMOVED - BOTH SIDES. FINAL TIGHTENING WILL OCCUR WHEN NUTS ARE TIGHTENED.
3. REMOVE REAR BUMPER BOLTS AND PLACE HITCH INTO POSITION AS SHOWN.
4. INSTALL REMAINING FASTENERS.

TIGHTEN ALL M12 FASTENERS TO 75 LB-FT.

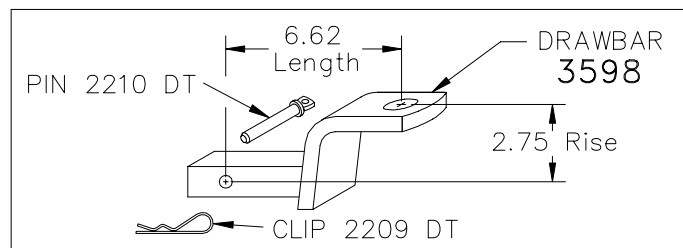

USE ONLY THE DRAWBAR SHOWN FOR CORRECT BUMPER CLEARANCE AND HEIGHT.  
DRAWBAR MUST BE USED IN THE RISE POSITION ONLY.

THIS PRODUCT COMPLIES WITH SAFETY SPECIFICATIONS AND REQUIREMENTS FOR CONNECTING DEVICES AND TOWING SYSTEMS OF THE STATE OF NEW YORK AND V.E.S.C. REGULATION V-5.

APPROX WEIGHT (LB.)

FASTENER KIT

28

F24702

NOTE: Check hitch frequently, making sure all fasteners and ball are properly tightened. If hitch is removed, plug all holes in trunk pan or other body panels to prevent entry of water and exhaust fumes. A hitch or ball which has been damaged should be removed and replaced. Observe safety precautions when working beneath a vehicle and wear eye protection. Follow car maker's specs for maximum trailer weight and tongue weight. Do not cut access or attachment holes with a torch.

**TOWING PRODUCTS**  
Plymouth, Michigan